

Listen to the Future

### APPLICATIONS

**Chrysler Sebring 2007**  
**Dodge Avenger 2007-2008**  
**Dodge Nitro 2007**

**Jeep Wrangler 2007**  
*(Modifications To Radio Cavity Required)*

### KIT FEATURES

- Double DIN Radio Provision
- Stacked ISO Units Provision



### KIT COMPONENTS

A) Double DIN Brackets/Trim Plates

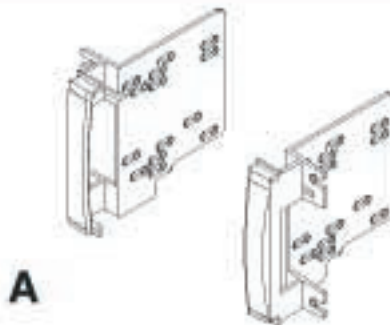

### TOOLS REQUIRED:

- Small Flat Blade Screwdriver/ Panel Removal Tool
- Phillips Screwdriver • Socket Set



## **TABLE OF CONTENTS**

### **Dash Disassembly**

- ***Chrysler Sebring 2007*** ..... 1
- ***Dodge Avenger 2007-2008*** ..... 2
- ***Dodge Nitro 2007*** ..... 3
- ***Jeep Wrangler 2007 (Modifications to radio cavity required)*** ..... 4

### **Kit Assembly**

- ***Double DIN Radio Provision*** ..... 5
- ***Stacked ISO Units Provision*** ..... 6

### **Final Assembly** ..... 7

**\*Note:**

**Refer also to the instructions included with the aftermarket radio.**

## **CHRYSLER SEBRING 2007**

- 1** Disconnect the negative battery terminal to prevent an accidental short circuit.
- 2** Unclip entire panel surrounding radio including a/c vents and clock. Unplug and remove panel. (Figure A)
- 3** Remove (4) 7MM screws securing radio. Unplug and remove radio. (Figure B)

*Continue to kit assembly.*

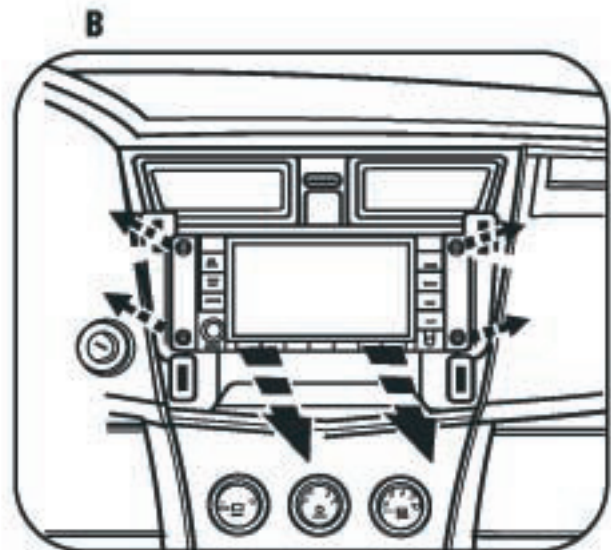



## **DODGE AVENGER 2007-2008**

- 1** Disconnect the negative battery terminal to prevent an accidental short circuit.
- 2** Unclip and remove the center console trim panel. (Figure A)
- 3** Unclip the center dash trim panel. (Figure B)
- 4** Remove (4) screws securing the radio. Disconnect and remove the radio. (Figure C)
- 5** Remove (3) screws securing the radio rear support bracket and remove the bracket. (Figure D)

*Continue to kit assembly.*

**A**

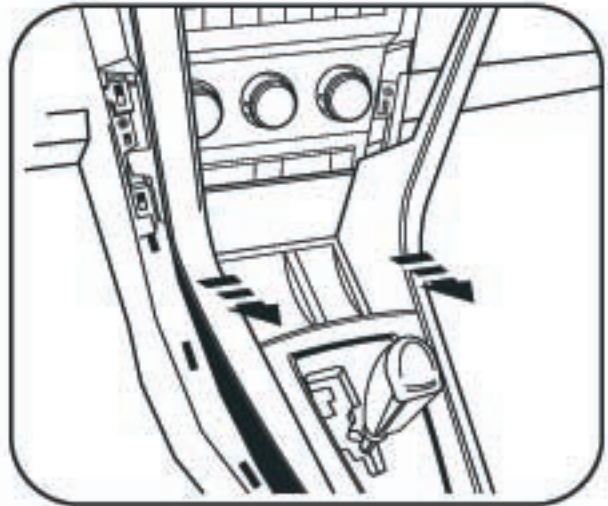

**B**

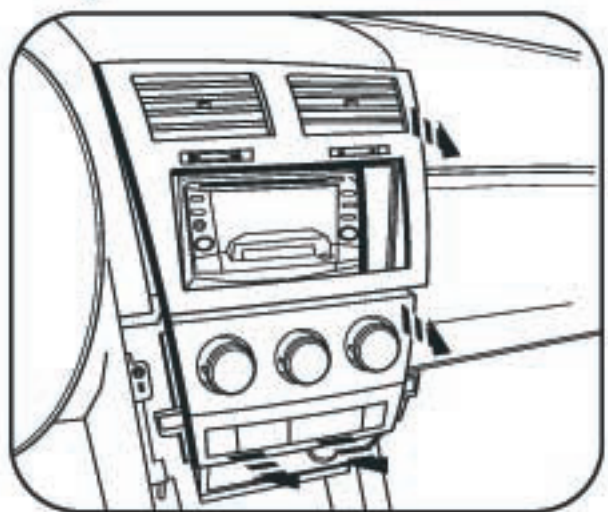

**C**

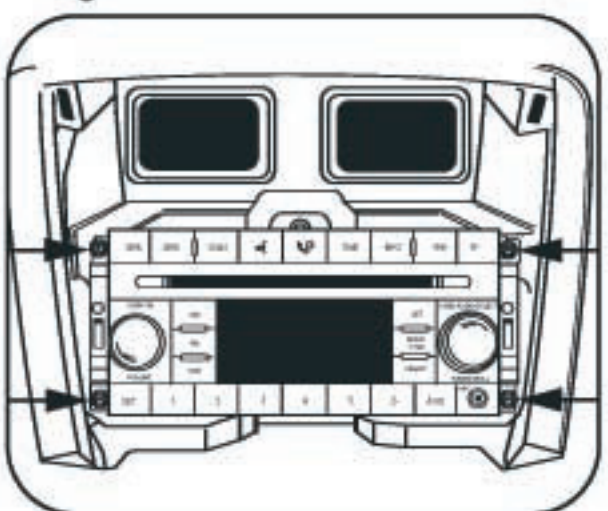

**D**

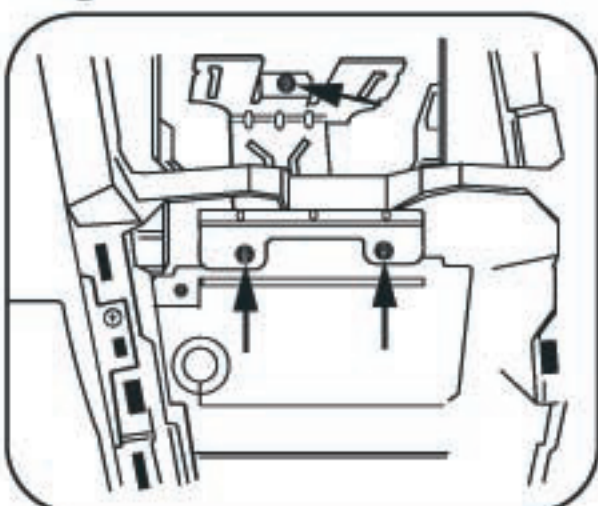

## **DODGE NITRO 2007**

- 1** Disconnect the negative battery terminal to prevent an accidental short circuit.
- 2** Unclip entire panel surrounding radio and climate controls, including a/c vents. Unplug and remove panel.
- 3** Remove (4) 7MM screws securing radio. Unplug and remove radio. (Figure B)

*Continue to kit assembly.*

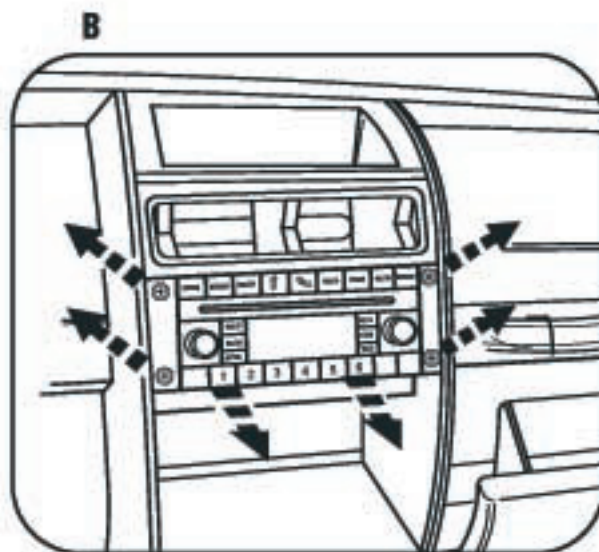
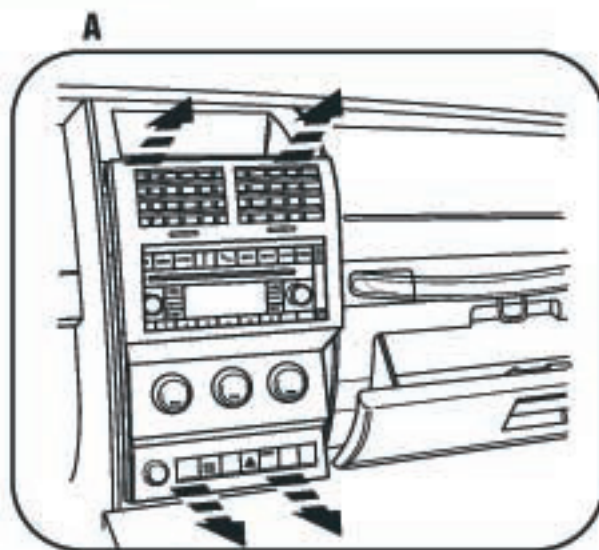

## **JEEP WRANGLER 2007**

*(Modifications To Radio Cavity Required)*

- 1** Disconnect the negative battery terminal to prevent an accidental short circuit.
- 2** Unclip and remove the lower center trim below a/c controls. (Figure A)
- 3** Remove (2) Phillips screws exposed behind lower center panel. (Figure A)
- 4** Unclip and remove the upper center trim starting towards the rear of the panel. (Figure A)
- 5** Remove (2) Phillips screws exposed behind upper center panel. (Figure A)
- 6** Unclip and remove entire panel surrounding radio and climate controls, including a/c vents.
- 7** Remove (4) 7MM screws securing radio. Unplug and remove radio. (Figure B)

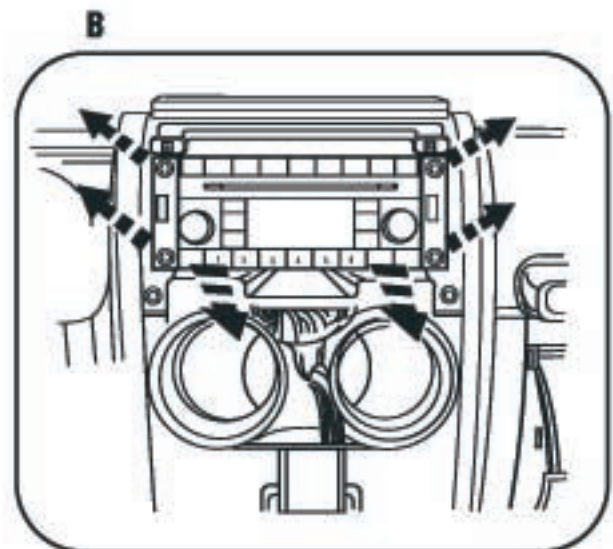
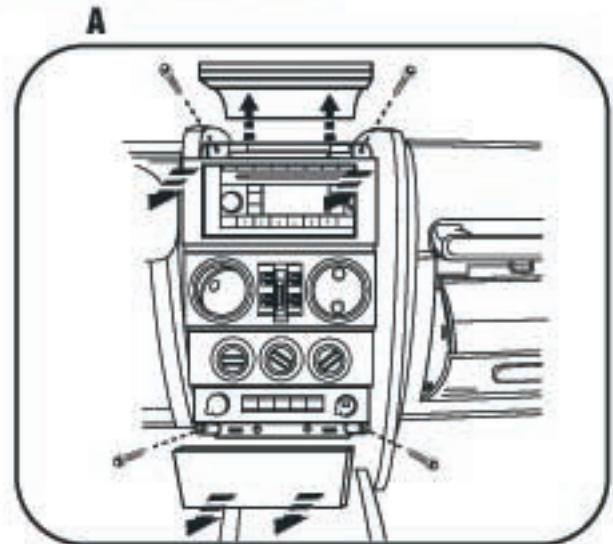

*Continue to kit assembly.*



## DOUBLE DIN RADIO PROVISION

*\*Note: Refer also to the instructions included with the aftermarket radio.*

- 1 Attach the Double DIN brackets/trim plates to the Double DIN Radio using the screws supplied with the Radio. (Figure A)

*Continue to final assembly.*

