

KENWOOD

CAW-CANOP1 CANBUS STEERING WHEEL COMMANDS ADAPTER FOR OPEL CORSA D rev 1.0.09



ATTENTION VERIFY THAT THE RADIO CANBUS LINE IS ACTIVATED OTHERWISE MAKE IT WITH OPEL DIAGNOSTIC PC SYSTEM

CAW-CANOP1 is an adapter for steering wheel commands in CANBUS; its compatibility extends to the **OPEL CORSA D** with a predisposition for OEM autoradios and to autoradios in the **KENWOOD** range with a wired remote input.

The module supplies a positive ignition, sidelights output, odometric signal as well as reverse gear, in the versions of the vehicle where such signals are present in CANBUS.

INSTALLATION:

The installation must be carried out by experienced personnel.

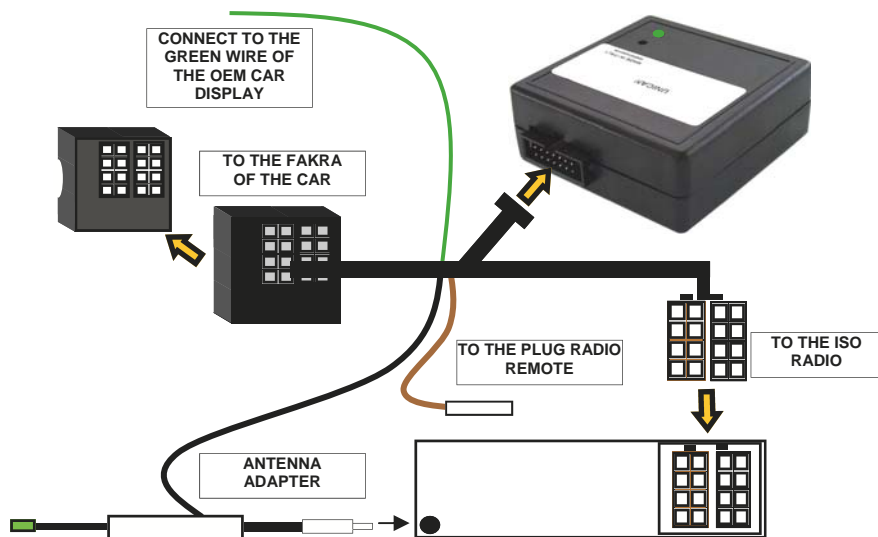

ONCE THE CONNECTIONS ARE MADE LED OF THE UNIT SWITCH ON GREEN TO CONFIRM THE RIGHT WORKING

HOW TO CONNECT THE CANBUS WIRE TO THE DISPLAY

To connect the canbus wire to the car it is necessary to do it directly to the display.
First of all remove the plastic panel shown below.

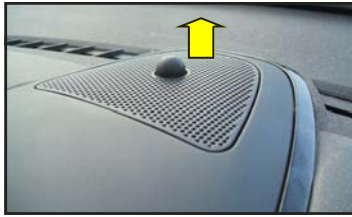

Once the panel is removed, please remove the torques that keeps the display chassis blocked.

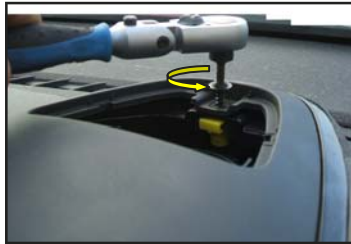

Once the torques is removed, detach the display with its plastic .

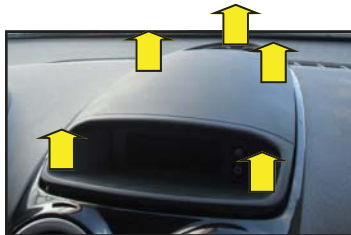

Now rotate the display so to have the acces to the connector of the display.

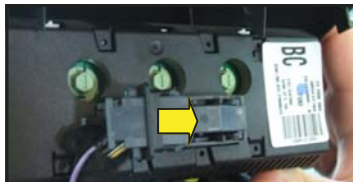
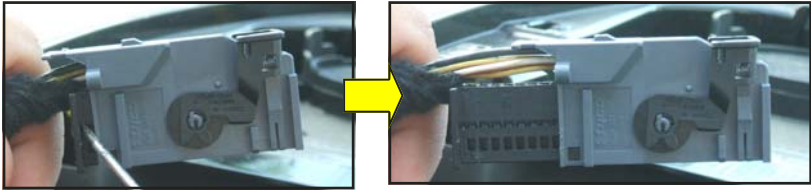
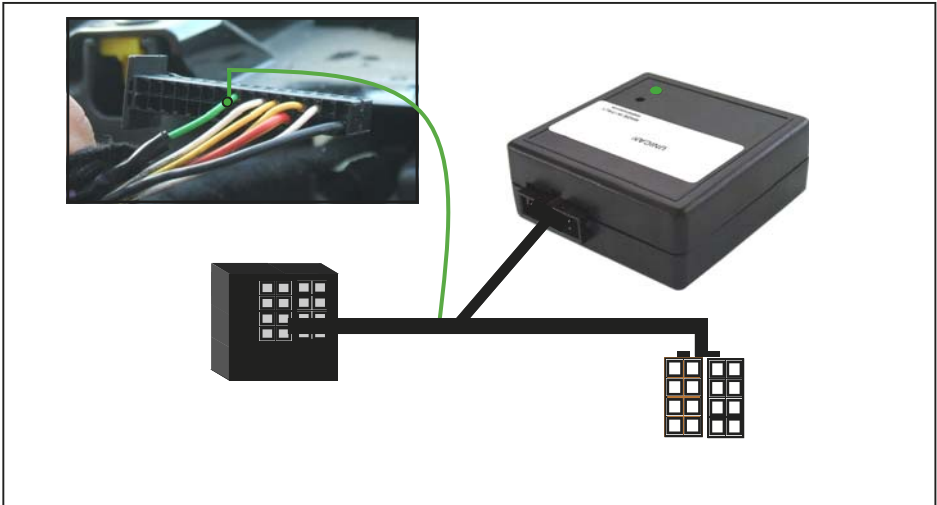

DIAGRAM OF CONNECTION

Once disconnected the plug from the display remove the connector inside as shown in the picture.



Now detect the GREEN wire and connect the GREEN wire of **CAW-CANOP1** .





BUTTONS ON THE STEERING WHEEL	KENWOOD	
	RADIO	CD
Roller or volume key	INCREASE VOLUME / DECREASE VOLUME	
Arrow up	SEEK +	TRACK +
Arrow down	SEEK —	TRACK —
Dot	MUTE	
Arrow or dotted line MODE	SOURCE	

FUNCTIONS	CABLE INTERFACE COLOUR
BACKGEAR	BLUE
HAND BRAKE	YELLOW WHITE
SPEED PULSE	GREY

TECHNICAL CHARACTERISTICS	
POWER SUPPLY	10/16 VDC
ABSORPTION AT REST	0,001 A
ABSORPTION WHEN WORKING	0,040 A
MAX CHARGE IGNITION KEY OUTPUT	0,50 A
MAX CHARGE SIDELIGHTS OUTPUT	0,040 A

WARRANTY CONDITIONS
THIS PRODUCT HAS A TWO-YEAR GUARANTEE FOR ANYKIND OF PRODUCTION DEFECT. THE FISCAL SALES DOCUMENT IS NECESSARY FOR THE VALIDITY OF THE GUARANTEE