

KENWOOD

KMM-361SD
KMM-261
KMM-100GY

KMM-100AY
KMM-100RY
KMM-120Y

DIGITAL MEDIA RECEIVER

INSTRUCTION MANUAL

ЦИФРОВОЙ МЕДИА-РЕСИВЕР

ИНСТРУКЦИЯ ПО ЭКСПЛУАТАЦИИ

ЦИФРОВИЙ МЕДІА-РЕСИВЕР

ІНСТРУКЦІЯ З ЕКСПЛУАТАЦІЇ

JVCKENWOOD Corporation



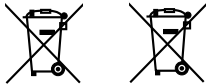

Pb

Information on Disposal of Old Electrical and Electronic Equipment and Batteries (applicable for EU countries that have adopted separate waste collection systems)

Products and batteries with the symbol (crossed-out wheeled bin) cannot be disposed as household waste.

Old electrical and electronic equipment and batteries should be recycled at a facility capable of handling these items and their waste byproducts.

Contact your local authority for details in locating a recycle facility nearest to you. Proper recycling and waste disposal will help conserve resources whilst preventing detrimental effects on our health and the environment.

Notice: The sign "Pb" below the symbol for batteries indicates that this battery contains lead.

For Israel

מידע בדבר השלכה לאשפה של ציוד חשמלי ואלקטרוני יש וכן סוללות (רלונטי) למדינות שמשמשות במערכת איסוף אשפה מופרדת).

לא ניתן להשליך מוצרים וסוללות עם הסימון (פח אשפה עם X עליו) כאשפה ביתית רגילה. יש למחזר ציוד חשמלי ואלקטרוני יש וכן סוללות במתקן המסוגל לטפל בפריטים כאלה ובתוצרי הלוואי שלהם. צרו קשר עם הרשות המקומית לקבלת פרטים אודות מתקן המיחזור הקרוב אליכם. מיחזור והשלכה לאשפה נאותים יעזרו לשמר משאבים ולמנוע השפעות שליליות על בריאותנו ועל הסביבה. שימו לב: הסימון Pb שמתחת לסימון עבור סוללות מצייין שהסוללה מכילה עופרת.



Declaration of Conformity with regard to the EMC Directive 2004/108/EC

Declaration of Conformity with regard to the RoHS Directive 2011/65/EU

Manufacturer:

JVC KENWOOD Corporation

3-12, Moriya-cho, Kanagawa-ku, Yokohama-shi, Kanagawa, 221-0022, Japan

EU Representative:

JVCKENWOOD NEDERLAND B.V.

Amsterdamseweg 37, 1422 AC UITHOORN, The Netherlands

For Turkey

Bu ürün 28300 sayılı Resmi Gazete'de yayımlanan Atık Elektrikli ve Elektronik Eşyaların Kontrolü Yönetmeliğe uygun olarak üretilmiştir.

Eski Elektrik ve Elektronik Ekipmanların İmha Edilmesi Hakkında Bilgi (ayrı atık toplama sistemlerini kullanan ülkeleri için uygulanabilir)



Semböllü (üzerinde çarpı işareti olan çöp kutusu) ürünler ev atıkları olarak atılamaz.

Eski elektrik ve elektronik ekipmanlar, bu ürünleri ve ürün atıklarını geri dönüştürebilecek bir tesiste değerlendirilmelidir. Yaşadığımız bölgeye en yakın geri dönüşüm tesisinin yerini öğrenmek için yerel makamlara müracaat edin. Uygun geri dönüşüm ve atık imha yöntemi sağlığımız ve çevremiz üzerindeki zararlı etkileri önlerken kaynakların korunmasına da yardımcı olacaktır.



Дата изготовления (месяц/год) находится на этикетке устройства.

В соответствии с Законом Российской Федерации “О защите прав потребителей” срок службы (годности) данного товара “по истечении которого он может представлять опасность для жизни, здоровья потребителя, причинять вред его имуществу или окружающей среде” составляет семь (7) лет со дня производства. Этот срок является временем, в течение которого потребитель данного товара может безопасно им пользоваться при условии соблюдения инструкции по эксплуатации данного товара, проводя необходимое обслуживание, включающее замену расходных материалов и/или соответствующее ремонтное обеспечение в специализированном сервисном центре.

Дополнительные косметические материалы к данному товару, поставляемые вместе с ним, могут храниться в течение двух (2) лет со дня его производства.

Срок службы (годности), кроме срока хранения дополнительных косметических материалов, упомянутых в предыдущих двух пунктах, не затрагивает никаких других прав потребителя, в частности, гарантийного свидетельства KENWOOD, которое он может получить в соответствии с законом о правах потребителя или других законов, связанных с ним.

Декларация про Відповідність Вимогам Технічного Регламенту Обмеження Використання деяких Небезпечних Речовин в електричному та електронному обладнанні (затвердженого Постановою №1057 Кабінету Міністрів України)

Вибір відповідає вимогам Технічного Регламенту Обмеження Використання деяких Небезпечних Речовин в електричному та електронному обладнанні (ТР ОВНР).

Вміст небезпечних речовин у випадках, не обумовлених в Додатку №2 ТР ОВНР:

- 1.** свинець (Pb) – не перевищує 0.1 % ваги речовини або в концентрації до 1000 частин на мільйон;
- 2.** кадмій (Cd) – не перевищує 0.01 % ваги речовини або в концентрації до 100 частин на мільйон;
- 3.** ртуть (Hg) – не перевищує 0.1 % ваги речовини або в концентрації до 1000 частин на мільйон;
- 4.** шестивалентний хром (Cr 6+) – не перевищує 0.1 % ваги речовини або в концентрації до 1000 частин на мільйон;
- 5.** полібромбіфеноли (PBВ) – не перевищує 0.1% ваги речовини або в концентрації до 1000 частин на мільйон;
- 6.** полібромдефенілові ефіри (PBDE) – не перевищує 0.1 % ваги речовини або в концентрації до 1000 частин на мільйон.

CONTENTS

| | |
|---------------------------|----|
| BEFORE USE | 2 |
| BASICS | 3 |
| GETTING STARTED | 4 |
| RADIO | 5 |
| AUX | 6 |
| USB/ iPod/ SD | 6 |
| DISPLAY SETTINGS | 8 |
| AUDIO SETTINGS | 9 |
| MORE INFORMATION | 10 |
| TROUBLESHOOTING | 10 |
| SPECIFICATIONS | 11 |
| INSTALLATION / CONNECTION | 12 |

How to read this manual

- Operations are explained mainly by using buttons on the faceplate.
- [XX] indicates the selected items.
- (→ XX) indicates references are available on the stated page.

BEFORE USE

▲ Warning

Do not operate any function that takes your attention away from safe driving.

▲ Caution

Volume setting:

- Adjust the volume so that you can hear sounds outside the car to prevent accidents.
- Lower the volume before playing digital sources to avoid damaging the speakers by the sudden increase of the output level.

General:

- Avoid using the external devices if it might hinder safe driving.
- Make sure all important data has been backed up. We shall bear no responsibility for any loss of recorded data.
- Never put or leave any metallic objects (such as coins or metal tools) inside the unit, to prevent a short circuit.

Muting upon the reception of a phone call

Connect the MUTE wire to your telephone using a commercial telephone accessory. (→ 13)

When a call comes in, "CALL" appears. (The audio system pauses.)

- To continue listening to the audio system during a call, press **SRC**. "CALL" disappears and the audio system resumes.

When the call ends, "CALL" disappears. (The audio system resumes.)

Maintenance

Cleaning the unit: Wipe off dirt on the faceplate with a dry silicone or soft cloth.

Cleaning the connector: Detach the faceplate and clean the connector gently with a cotton swab, being careful not to damage the connector.

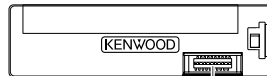

Connector (on the reverse side of the faceplate)

BASICS

Faceplate

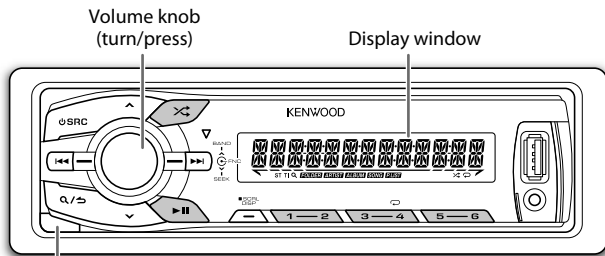

Detach button

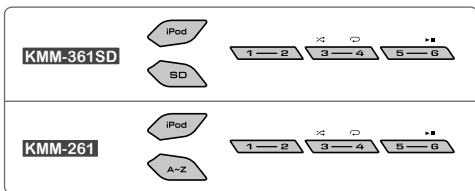

Attach

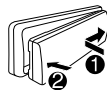

Detach

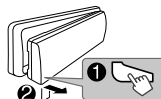

How to reset

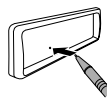

Your preset adjustments will also be erased.

Insert an SD card (for **KMM-361SD**)

- 1 Press **SRC** to turn off the power.
- 2 Detach the faceplate.
- 3 Insert the SD card into the SD CARD slot until it clicks.
(With the label side up and the notched section on the right.)

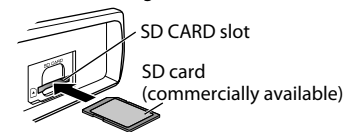

- 4 Reattach the faceplate.

Removing an SD card (for **KMM-361SD**)

- 1 Detach the faceplate.
- 2 Push the SD card until it clicks and then pull it out.
- 3 Reattach the faceplate.

| To | Do this (on the faceplate) |
|--------------------------------|---|
| Turn on the power | Press SRC . • Press and hold to turn off the power. |
| Adjust the volume | Turn the volume knob. |
| Select a source | Press SRC repeatedly. |
| Change the display information | Press DISP SCRL repeatedly. • Press and hold to scroll the current display information. |

GETTING STARTED

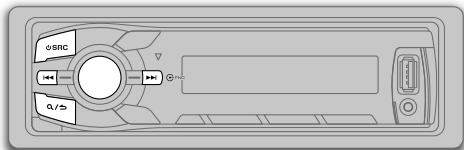

1 Select the display language and cancel the demonstration

When you turn on the power (or after you reset the unit), the display shows: "SEL LANGUAGE" → "PRESS" → "VOLUME KNOB"

- 1 Turn the volume knob to select [ENG] (English) or [RUS] (Russian), then press the knob.

[ENG] is selected for the initial setup.

Then, the display shows: "CANCEL DEMO" → "PRESS" → "VOLUME KNOB"

- 2 Press the volume knob.
[YES] is selected for the initial setup.
- 3 Press the volume knob again.
"DEMO OFF" appears.

2 Set the clock

- 1 Press the volume knob to enter [FUNCTION].
- 2 Turn the volume knob to select [CLOCK], then press the knob.
- 3 Turn the volume knob to select [CLOCK ADJUST], then press the knob.
- 4 Turn the volume knob to make the settings, then press the knob.
Day → Hour → Minute
- 5 Turn the volume knob to select [CLOCK FORMAT], then press the knob.
- 6 Turn the volume knob to select [12H] or [24H], then press the knob.

- 7 Press and hold Q/PS to exit.

To return to the previous setting item or hierarchy, press Q/PS.

While in clock display screen...

Press and hold **DISP SCRL** to enter clock adjustment mode directly.
Then, perform step 4 to set the clock.

3 Set the initial settings

- 1 Press SRC to enter STANDBY.
- 2 Press the volume knob to enter [FUNCTION].
- 3 Turn the volume knob to make a selection (see the following table), then press the knob.
- 4 Press and hold Q/PS to exit.

To return to the previous setting item or hierarchy, press Q/PS.

Default: **XX**

AUDIO CONTROL

SWITCH PREOUT **REAR/ SUB-W:** Selects whether rear speakers or a subwoofer are connected to the line out terminals on the rear (through an external amplifier).

SP SELECT **OFF/ 5/4/ 6 × 9/6/ OEM:** Selects according to the speaker size (5 inches or 4 inches, 6×9 inches or 6 inches) or OEM speakers for optimum performance.

DISPLAY

EASY MENU (For **KMM-361SD** / **KMM-120Y**)
ON: Both display and button illumination change to white color when entering [FUNCTION]. ; **OFF:** Both display and button illumination remain as [COLOR SELECT] color. (→ 8)

TUNER SETTING

PRESET TYPE **NORMAL:** Memorizes one station for each preset button in each band (FM1/ FM2/ FM3/ MW/ LW). ; **MIX:** Memorizes one station for each preset button, regardless of the selected band.

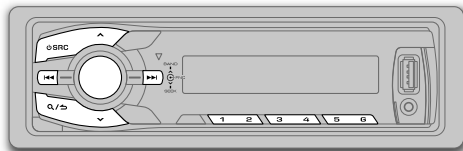
Default: **XX****SYSTEM**

KEY BEEP **ON:** Activates the keypress tone. ;
OFF: Deactivates.

SOURCE SELECT

BUILT-IN AUX **ON:** Enables AUX in source selection. ;
OFF: Disables. (→ 6)

RUSSIAN SET Selects the display language for [FUNCTION] menu and Tag information (folder name, file name, song title, artist name, album name) if applicable.
RUSSIAN OFF: Display language is English. ; **РУССКИЙ ВКЛ:** Display language is Russian.

P-OFF WAIT Applicable only when the demonstration mode is turned off.
 Sets the duration when the unit will automatically turns off (while in standby mode) to save the battery.
20M: 20 minutes ; **40M:** 40 minutes ;
60M: 60 minutes ; **OFF** ----: Cancels

F/W UPDATE**UPDATE SYSTEM**

F/W UP xx.xx **YES:** Starts upgrading the firmware. ;
NO: Cancels (upgrading is not activated).
 For details on how to update the firmware, see: www.kenwood.com/cs/ce/

Search for a station

- 1 Press **SRC** to select TUNER.
 - 2 Press **^ BAND** repeatedly to select FM1/ FM2/ FM3/ MW/ LW.
 - 3 Press **◀◀ / ▶▶** to search for a station.
- To change the searching method for **◀◀ / ▶▶**: Press **∨ SEEK** repeatedly.
 - **AUTO1:** Automatically search for a station.
 - **AUTO2:** Automatically search for a preset station.
 - **MANUAL:** Manually search for a station.
 - To store a station: Press and hold one of the number buttons (**1** to **6**).
 - To select a stored station: Press one of the number buttons (**1** to **6**).

Other settings

- 1 Press the volume knob to enter [FUNCTION].
- 2 Turn the volume knob to make a selection (see the following table), then press the knob.
- 3 Press and hold **Q/↵** to exit.

To return to the previous setting item or hierarchy, press **Q/↵**.

Default: **XX****TUNER SETTING**

- LOCAL SEEK** **ON:** Searches only FM stations with good reception. ; **OFF:** Cancels.
- AUTO MEMORY** **YES:** Automatically starts memorizing 6 stations with good reception. ;
NO: Cancels. (Selectable only if [NORMAL] is selected for [PRESET TYPE].) (→ 4)
- MONO SET** **ON:** Improves the FM reception, but the stereo effect may be lost. ; **OFF:** Cancels.
- NEWS SET** **ON:** The unit will temporarily switch to News Programme if available. ;
OFF: Cancels.
- REGIONAL** **ON:** Switches to another station only in the specific region using the "AF" control. ;
OFF: Cancels.
- AF SET** **ON:** Automatically searches for another station broadcasting the same program in the same Radio Data System network with better reception when the current reception is poor. ; **OFF:** Cancels.
- TI** **ON:** Allows the unit to temporarily switch to Traffic Information. ; **OFF:** Cancels.

RADIO

Default: **XX**

PTY SEARCH Press the volume knob to enter PTY language selection. Turn the volume knob to select the PTY language (**ENGLISH/ FRENCH/ GERMAN**), then press the knob. Selects the available Program Type (see the following), then, press **◀◀ / ▶▶** to start.

CLOCK

TIME SYNC **ON**: Synchronizes the unit's time to the Radio Data System station time. ;
OFF: Cancels.

• **[LOCAL SEEK]/ [MONO SET]/ [NEWS SET]/ [REGIONAL]/ [AF SET]/ [TI]/ [PTY SEARCH]** is selectable only when the band is FM1/ FM2/ FM3.

• Available Program Type:

SPEECH: NEWS, AFFAIRS, INFO (information), SPORT, EDUCATE, DRAMA, CULTURE, SCIENCE, VARIED, WEATHER, FINANCE, CHILDREN, SOCIAL, RELIGION, PHONE IN, TRAVEL, LEISURE, DOCUMENT

MUSIC: POP M (music), ROCK M (music), EASY M (music), LIGHT M (music), CLASSICS, OTHER M (music), JAZZ, COUNTRY, NATION M (music), OLDIES, FOLK M (music)

The unit will search for the Program Type categorized under **[SPEECH]** or **[MUSIC]** if selected.

• If the volume is adjusted during reception of traffic information, alarm or news bulletin, the adjusted volume is memorized automatically. It will be applied the next time traffic information, alarm or news bulletin function is turned on.

AUX

Preparation:

Select **[ON]** for **[BUILT-IN AUX]**. (→ 5)

Start listening

1 Connect a portable audio player (commercially available).

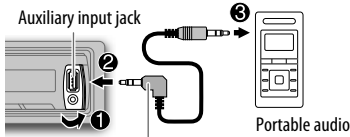

3.5 mm stereo mini plug with "L" shaped connector (commercially available)

2 Press **⏻ SRC** to select **AUX**.

3 Turn on the portable audio player and start playback.

Set the AUX name

While listening to a portable audio player connected to the unit...

1 Press the volume knob to enter **[FUNCTION]**.

2 Turn the volume knob to select **[SYSTEM]**, then press the knob.

3 Turn the volume knob to select **[AUX NAME SET]**, then press the knob.

4 Turn the volume knob to make a selection, then press the knob.

AUX (default)/ **DVD**/ **PORTABLE**/ **GAME**/ **VIDEO**/ **TV**

5 Press and hold **Q / ↵** to exit.

USB/ iPod/ SD

Start playback

USB/ iPod: The source changes automatically and playback starts.

USB

USB input terminal

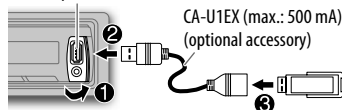

iPod/iPhone (for **KMM-361SD** / **KMM-261**)

USB input terminal

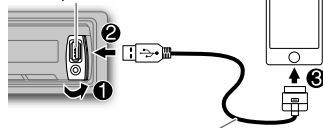

KCA-iP102 (optional accessory)

• You can also change the source from the other source to iPod by pressing **iPod**.

Press and hold **iPod** to select the control mode while in iPod source.

MODE ON: From the iPod*1.



MODE OFF: From the unit.

SD (for **KMM-361SD**)

Insert an SD card into the SD CARD slot. (→ 3)
Press **⏻ SRC** or **SD** to select SD and start playback.

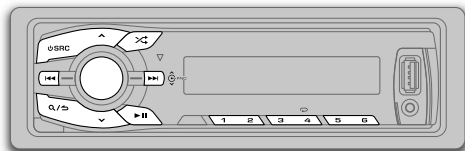
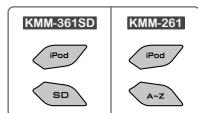
• You can also change the source from the other source to SD by pressing **SD**.

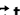

| To | Do this |
|-------------------------------|--|
| Pause or resume playback | Press ▶ or 6 ▶ . |
| Select a file | Press ◀◀ / ▶▶ . |
| Select a folder ^{*2} | Press ^ / v . |
| Reverse/ Fast-forward | Press and hold ◀◀ / ▶▶ . |
| Repeat play ^{*3} | Press 4  repeatedly. <ul style="list-style-type: none"> MP3/WMA/WAV/FLAC file or iPod: FILE REPEAT, FOLDER REPEAT, REPEAT OFF KENWOOD Music Editor Light (KME Light)/ KENWOOD Music Control (KMC) file (➔ 10): FILE REPEAT, REPEAT OFF |
| Random play ^{*3} | Press ↻ or 3  repeatedly. <ul style="list-style-type: none"> MP3/WMA/WAV/FLAC file or iPod or KME Light/ KMC file: FOLDER RANDOM, RANDOM OFF <p>Press and hold ↻ or 3  to select "ALL RANDOM".</p> |

^{*1} You can still play/pause, file skip, fast-forward or reverse files from the unit.

^{*2} Only for MP3/WMA/WAV/FLAC files. This does not work for iPod.

^{*3} For iPod: Applicable only when [MODE OFF] is selected. (➔ 6)

If you connect the iPod/iPhone to the USB input terminal of the unit (while listening to Tuneln, Tuneln Radio Pro or Aupeo), the unit will output the sound from these apps.

Select a file from a list

For iPod: Applicable only when [MODE OFF] is selected. (➔ 6)

- 1 Press **Q/↵**.
- 2 Turn the volume knob to make a selection, then press the knob.

- MP3/WMA/WAV/FLAC file: Select the desired folder, then a file.
- iPod or KME Light/ KMC file: Select the desired file from the list (PLAYLISTS, ARTISTS, ALBUMS, SONGS, PODCASTS*, GENRES, COMPOSERS*).

* Only for iPod.

- To return to the root folder (or first file), press number button **5**.
- To return to the previous setting item or hierarchy, press **Q/↵**.
- To cancel, press and hold **Q/↵**.

If you have many files...

You can search through them quickly (on step 2 above) at a preset skip search ratio by pressing **◀◀ / ▶▶**.

- See also "Set the skip search ratio." (➔ 8)
- Pressing and holding **◀◀ / ▶▶** skip songs at the maximum ratio (10%) regardless of the setting made.
- For USB: Only for files registered in the database created with KME Light/ KMC.

Select a song by name

While listening to iPod...

- 1 Press **Q/↵**.
- 2 Turn the volume knob to select a category, then press the knob.
- 3 Turn the volume knob quickly (or press **A~Z** for **[KMM-267]**) to enter character search.
- 4 Turn the volume knob to select the character to be searched for.
- 5 Press **◀◀/▶▶** to move to the entry position.
You can enter up to 3 characters.
- 6 Press the volume knob to start searching.
- 7 Turn the volume knob to make a selection, then press the knob.
Repeat step 7 until the desired item is selected.

- To search for a character other than A to Z and 0 to 9, enter only “*”.
- To return to the previous hierarchy, press **Q/↵**.
- To return to the top menu, press number button 5.
- To cancel, press and hold **Q/↵**.

Set the skip search ratio

While listening to iPod or KME Light/ KMC file...

- 1 Press the volume knob to enter [FUNCTION].
- 2 Turn the volume knob to select [USB], then press the knob.
- 3 Turn the volume knob to select [SKIP SEARCH], then press the knob.
- 4 Turn the volume knob to make a selection, then press the knob.
0.5% (default)/ 1%/ 5%/ 10%: Skip search ratio over the total files.
- 5 Press and hold **Q/↵** to exit.

Change the USB drive

When a smartphone (Mass Storage Class) is connected to the USB input terminal, you can select its internal memory or external memory (such as an SD card) to playback the stored songs. You can also select the desired drive to playback when a multiple drives device is connected.

Press number button 5 repeatedly to select the desired drive.

(or)

- 1 Press the volume knob to enter [FUNCTION].
- 2 Turn the volume knob to select [USB], then press the knob.
- 3 Turn the volume knob to select [MUSIC DRIVE], then press the knob.
- 4 Press the volume knob to select [DRIVE CHANGE].

The next drive is selected automatically.

Repeat steps 1 to 4 to select the following drives.

Selectable items: [DRIVE 1] to [DRIVE 5]

- 1 Press the volume knob to enter [FUNCTION].
- 2 Turn the volume knob to select [DISPLAY], then press the knob.
- 3 Turn the volume knob to make a selection (see the following table), then press the knob.
Repeat step 3 until the desired item is selected or activated.
- 4 Press and hold **Q/↵** to exit.

To return to the previous setting item or hierarchy, press **Q/↵**.

Default: **XX**

| | |
|----------------------|--|
| COLOR SELECT* | VARIABLE SCAN/ COLOR 01 — COLOR 24/ USER: Selects your preferred button illumination color. You can create your own color (when [COLOR 01] — [COLOR 24] or [USER] is selected). The color you have created can be selected when you select [USER]. 1 Press and hold the volume knob to enter the detailed color adjustment. 2 Press ◀◀/▶▶ to select the color (R/ G/ B) to adjust. 3 Turn the volume knob to adjust the level (0 — 9), then press the knob. |
| DIMMER | ON: Dims the display illumination (and button illumination*). ; OFF: Illuminates according to the [BRIGHTNESS] settings. |
| BRIGHTNESS | LVL 0 — LVL 31: Selects your preferred brightness level for display illumination (and button illumination*). |
| TEXT SCROLL | AUTO/ ONCE: Selects whether to scroll the display information automatically, or scroll only once. ; OFF: Cancels. |

* For **[KMM-361SD/ KMM-120Y]**

AUDIO SETTINGS

While listening to any source...

- 1 Press the volume knob to enter [FUNCTION].
- 2 Turn the volume knob to select [AUDIO CONTROL], then press the knob.
- 3 Turn the volume knob to make a selection (see the following table), then press the knob.
Repeat step 3 until the desired item is selected or activated.
- 4 Press and hold \mathcal{Q} / \mathcal{S} to exit.

To return to the previous setting item or hierarchy, press \mathcal{Q} / \mathcal{S} .

Default: **XX**

| | | |
|--------------------|----------------------|---|
| SUB-W LEVEL | -15 to +15 (0) | Adjusts the subwoofer output level. |
| BASS LEVEL | -8 to +8 (+6) | Adjusts the level to memorize for each source. (Before making an adjustment, select the source you want to adjust.) |
| MID LEVEL | -8 to +8 (+5) | |
| TRE LEVEL | -8 to +8 (0) | |
| EQ PRO | | |
| BASS ADJUST | BASS CTR FRQ | 60/ 80/ 100/ 200: Selects the center frequency. |
| | BASS LEVEL | -8 to +8 (+6): Adjusts the level. |
| | BASS Q FACTOR | 1.00/ 1.25/ 1.50/ 2.00: Adjusts the quality factor. |
| | BASS EXTEND | ON: Turns on the extended bass. ; OFF: Cancels. |
| MID ADJUST | MID CTR FRQ | 0.5/ 1.0/ 1.5/ 2.5K: Selects the center frequency. |
| | MID LEVEL | -8 to +8 (+5): Adjusts the level. |
| | MID Q FACTOR | 0.75/ 1.00/ 1.25: Adjusts the quality factor. |
| TRE ADJUST | TRE CTR FRQ | 10.0/ 12.5/ 15.0/ 17.5K: Selects the center frequency. |
| | TRE LEVEL | -8 to +8 (0): Adjusts the level. |

| | |
|--|---|
| PRESET EQ | DRIVE EQ/ TOP40/ POWERFUL/ ROCK/ POPS/ EASY/ JAZZ/ NATURAL/ USER: Selects a preset equalizer suitable to the music genre. (Select [USER] to use the customized bass, middle, and treble settings.) [DRIVE EQ] is a preset equalizer that reduces noise from the road. |
| BASS BOOST | LV1/ LV2/ LV3: Selects your preferred bass boost level. ; OFF: Cancels. |
| LOUDNESS | LV1/ LV2: Selects your preferred low and high frequencies boost to produce a well-balanced sound at a low volume level. ; OFF: Cancels. |
| SUBWOOFER SET | ON: Turns on the subwoofer output. ; OFF: Cancels. |
| LPF SUBWOOFER | THROUGH: All signals are sent to the subwoofer. ; 85HZ/ 120HZ/ 160HZ: Audio signals with frequencies lower than 85 Hz/ 120 Hz/ 160 Hz are sent to the subwoofer. |
| SUB-W PHASE | REVERSE (180°)/ NORMAL (0°): Selects the phase of the subwoofer output to be in line with the speaker output for optimum performance. (Selectable only if a setting other than [THROUGH] is selected for [LPF SUBWOOFER].) |
| FADER | R15 to F15 (0): Adjusts the rear and front speaker output balance. |
| BALANCE | L15 to R15 (0): Adjusts the left and right speaker output balance. |
| VOLUME OFFSET (Default: 0) | -8 to +8 (for AUX); -8 to 0 (for other sources): Presets the volume adjustment level of each source. (Before adjustment, select the source you want to adjust.) |
| SOUND RECNRSTR (Sound reconstruction) | ON: Creates realistic sound by compensating the high-frequency components and restoring the rise-time of the waveform that are lost in audio data compression. ; OFF: Cancels. |

- [SUB-W LEVEL]/ [SUBWOOFER SET]/ [LPF SUBWOOFER]/ [SUB-W PHASE] is selectable only if [SWITCH PREOUT] is set to [SUB-W]. (→ 4)
- [SUB-W LEVEL]/ [LPF SUBWOOFER]/ [SUB-W PHASE] is selectable only if [SUBWOOFER SET] is set to [ON].

MORE INFORMATION

General

Detailed information and notes about the playable audio files are stated in an online manual on the following web site:

www.kenwood.com/cs/ce/audiofile/

Playable files

- Playable audio file: MP3 (.mp3), WMA (.wma), WAV (.wav), FLAC (.flac)
- Playable USB device file system: FAT12, FAT16, FAT32

Even when audio files comply with the standards listed above, playback may be impossible depending on the types or conditions of media or device.

About USB devices

- This unit can play MP3/WMA/WAV/FLAC files stored on a USB mass storage class device.
- You cannot connect a USB device via a USB hub.
- Connecting a cable whose total length is longer than 5 m may result in abnormal playback.
- This unit cannot recognize a USB device whose rating is other than 5 V and exceeds 1 A.

About SD card

- This unit is capable of playback of SD/SDHC memory cards complying with the SD or SDHC standard:
SD card (≤2 GB), SDHC card (≤32 GB)
- A special adapter is required to use a miniSD card, miniSDHC card, microSD card or microSDHC card.
- The MultiMedia Card (MMC) cannot be used.
- Data recorded in the SD audio format cannot be played back.

About KENWOOD Music Editor Light and KENWOOD Music Control

- This unit supports the PC application KENWOOD Music Editor Light and Android™ application KENWOOD Music Control.
- When you play audio files with song data added using the KENWOOD Music Editor Light or KENWOOD Music Control, you can search for audio files by Genres, Artists, Albums, Playlists, and Songs.
- KENWOOD Music Editor Light and KENWOOD Music Control are available on the following web site:
www.kenwood.com/cs/ce/

About iPod/iPhone

Made for

- iPod touch (1st, 2nd, 3rd, 4th, and 5th generation)
- iPod classic
- iPod nano (3rd, 4th, 5th, 6th, and 7th generation)
- iPhone, iPhone 3G, 3GS, 4, 4S, 5
- For the latest compatible list and software versions of iPhone/iPod, see: www.kenwood.com/cs/ce/ipod
- To connect devices featuring Lightning connector, both KCA-iP102 (optional accessory) and Apple Lightning to 30-pin Adapter (accessory of the iPod/iPhone) are required.
Do not leave the Apple Lightning to 30-pin Adapter inside the car to prevent damages caused by the hot temperature.
- You cannot operate iPod if “KENWOOD” or “✓” is displayed on iPod.

TROUBLESHOOTING

| Symptom | Remedy |
|--|---|
| Sound cannot be heard. | <ul style="list-style-type: none">• Adjust the volume to the optimum level.• Check the cords and connections. |
| “PROTECT” appears and no operations can be done. | Check to be sure the terminals of the speaker wires are insulated properly, then reset the unit. If this does not solve the problem, consult your nearest service center. |
| <ul style="list-style-type: none">• Sound cannot be heard.• The unit does not turn on.• Information shown on the display is incorrect. | Clean the connectors. (➡ 2) |
| The unit does not work at all. | Reset the unit. (➡ 3) |
| <ul style="list-style-type: none">• Radio reception is poor.• Static noise while listening to the radio. | <ul style="list-style-type: none">• Connect the antenna firmly.• Pull the antenna out all the way. |
| “NA FILE” appears. | Make sure the media contains supported audio files. (➡ 10) |
| “READ ERROR” appears. | Copy the files and folders onto the USB device again. If this does not solve the problem, reset the USB device or use another USB device. |
| “NO DEVICE” appears. | <ul style="list-style-type: none">• Connect a USB device, and change the source to USB again.• SD card is not inserted properly. Insert an SD card, and change the source to SD again. |
| “COPY PRO” appears. | A copy-protected file is played. |
| “NA DEVICE” appears. | <ul style="list-style-type: none">• Connect a supported USB device, and check the connections.• Insert a supported SD card properly. |
| “NO MUSIC” appears. | Connect a USB device or insert an SD card that contains playable audio files. |
| “iPod ERROR” appears. | Reconnect the iPod. / Reset the iPod. |
| “READING” keeps flashing. | Do not use too many hierarchical levels or folders. |
| Elapsed playing time is not correct. | This is caused by how the tracks are recorded. |
| Correct characters are not displayed (e.g. album name). | This unit can only display uppercase letters, numbers, and a limited number of symbols. Uppercase Cyrillic letters can also be displayed if [RUSSIAN SET] is set to [РУССКИЙ ВКЛ]. (➡ 5) |

SPECIFICATIONS

| | | | |
|--------|----------------------------------|--|--|
| Tuner | FM | Frequency Range | 87.5 MHz — 108.0 MHz (50 kHz space) |
| | | Usable Sensitivity (S/N = 26 dB) | 0.71 μ V/75 Ω |
| | | Quieting Sensitivity (DIN S/N = 46 dB) | 2.0 μ V/75 Ω |
| | | Frequency Response (\pm 3 dB) | 30 Hz — 15 kHz |
| | | Signal-to-Noise Ratio (MONO) | 64 dB |
| | | Stereo Separation (1 kHz) | 40 dB |
| MW | Frequency Range | 531 kHz — 1 611 kHz (9 kHz space) | |
| | Usable Sensitivity (S/N = 20 dB) | 28.2 μ V | |
| LW | Frequency Range | 153 kHz — 279 kHz (9 kHz space) | |
| | Usable Sensitivity (S/N = 20 dB) | 50 μ V | |
| USB/SD | USB | USB Standard | USB 1.1, USB 2.0 (Full speed) |
| | | File System | FAT 12/ 16/ 32 |
| | | Maximum Supply Current | DC 5 V $\overline{\text{---}}$ 1 A |
| | | Frequency Response (\pm 1 dB) | 20 Hz — 20 kHz |
| | | Signal-to-Noise Ratio (1 kHz) | 105 dB |
| | | Dynamic Range | 88 dB |
| | | Channel Separation | 90 dB |
| | SD | Compatible Physical Format | Version 2.00 |
| | | Maximum Memory Capacity | 32 GB |
| | | File System | FAT 12/ 16/ 32 |
| | | MP3 Decode | Compliant with MPEG-1/2 Audio Layer-3 |
| | | WMA Decode | Compliant with Windows Media Audio |
| | | WAV Decode | RIFX waveform Audio Format (Linear PCM only) |
| | FLAC Decode | FLAC files | |

| | | | |
|-------------------|---|--|---------------------|
| Audio | Maximum Output Power | 50 W \times 4 | |
| | Output Power (DIN 45324, +B = 14.4 V) | 30 W \times 4 | |
| | Speaker Impedance | 4 Ω — 8 Ω | |
| | Tone Action | Bass | 200 Hz \pm 8 dB |
| | | Middle | 2.5 kHz \pm 8 dB |
| | | Treble | 12.5 kHz \pm 8 dB |
| Preout Level/Load | 2 500 mV/ 10 k Ω (USB) | | |
| Preout Impedance | \leq 600 Ω | | |
| Auxiliary | Frequency Response (\pm 3 dB) | 20 Hz — 20 kHz | |
| | Input Maximum Voltage | 1 200 mV | |
| | Input Impedance | 30 k Ω | |
| General | Operating Voltage | 14.4 V (10.5 V — 16 V allowable) | |
| | Maximum Current Consumption | 10 A | |
| | Operational Temperature Range | 0 $^{\circ}$ C — +40 $^{\circ}$ C | |
| | Installation Size (W \times H \times D) | 182 mm \times 53 mm \times 107 mm | |
| | Weight | KMM-120Y : 0.55 kg Other models : 0.54 kg | |

Subject to change without notice.

▲ Warning

- The unit can only be used with a 12 V DC power supply, negative ground.
- Disconnect the battery's negative terminal before wiring and mounting.
- Do not connect Battery wire (yellow) and Ignition wire (red) to the car chassis or Ground wire (black) to prevent a short circuit.
- Insulate unconnected wires with vinyl tape to prevent a short circuit.
- Be sure to ground this unit to the car's chassis again after installation.

▲ Caution

- For safety's sake, leave wiring and mounting to professionals. Consult the car audio dealer.
- Install this unit in the console of your vehicle. Do not touch the metal parts of this unit during and shortly after use of the unit. Metal parts such as the heat sink and enclosure become hot.
- Do not connect the \ominus wires of speakers to the car chassis or Ground wire (black), or connect them in parallel.
- Mount the unit at an angle of less than 30°.
- If your vehicle wiring harness does not have the ignition terminal, connect Ignition wire (red) to the terminal on the vehicle's fuse box which provides 12 V DC power supply and is turned on and off by the ignition key.
- After the unit is installed, check whether the brake lamps, blinkers, wipers, etc. on the car are working properly.
- If the fuse blows, first make sure the wires are not touching car's chassis, then replace the old fuse with one that has the same rating.

Basic procedure

- 1 Remove the key from the ignition switch, then disconnect the \ominus terminal of the car battery.
- 2 Connect the wires properly. See Wiring connection. (→ 13)
- 3 Install the unit to your car. See Installing the unit (in-dash mounting).
- 4 Connect the \ominus terminal of the car battery.
- 5 Reset the unit. (→ 3)

Installing the unit (in-dash mounting)

1

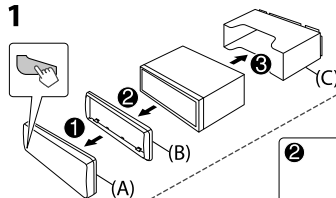

2 Do the required wiring.
(→ 13)

2

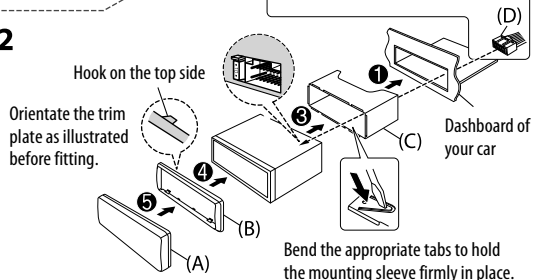

How to remove the unit

- 1 Detach the faceplate.
- 2 Fit the catch pin on the extraction keys into the holes on both sides of the trim plate, then pull it out.
- 3 Insert the extraction keys deeply into the slots on each side, then follow the arrows as shown on the right.

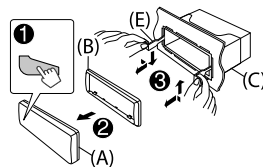

Part list for installation

(A) Faceplate

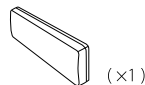

(B) Trim plate

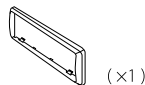

(C) Mounting sleeve

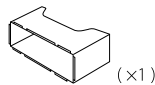

(D) Wiring harness

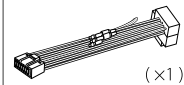

(E) Extraction key



Wiring connection

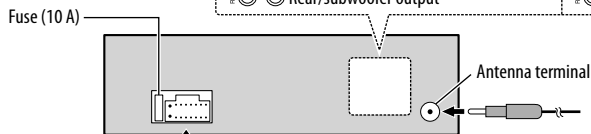
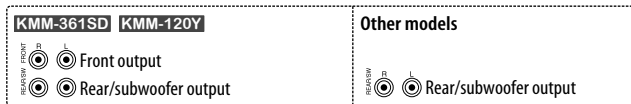

Connecting the ISO connectors on some VW/Audi or Opel (Vauxhall) automobiles

You may need to modify the wiring of the supplied wiring harness as illustrated below.

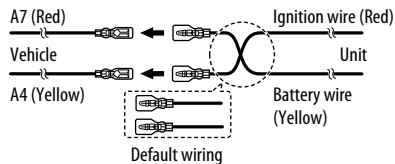

| Pin | Color and function |
|-----|---------------------------------------|
| A4 | Yellow : Battery |
| A5 | Blue/White : Power control |
| A7 | Red : Ignition (ACC) |
| A8 | Black : Earth (ground) connection |
| B1 | Purple ⊕ : Rear speaker (right) |
| B2 | Purple/black ⊖ : Rear speaker (right) |
| B3 | Gray ⊕ : Front speaker (right) |
| B4 | Gray/black ⊖ : Front speaker (right) |
| B5 | White ⊕ : Front speaker (left) |
| B6 | White/black ⊖ : Front speaker (left) |
| B7 | Green ⊕ : Rear speaker (left) |
| B8 | Green/black ⊖ : Rear speaker (left) |

